



Certificate

Nr. SR66-2310-1050C01

U Septic Tank

Molloy Environmental Systems
Coleraine, Clara Road, Tullamore, Co Offaly, Ireland

EN 12566-1

Part 1: Prefabricated septic tanks
Results corresponding to EN 12566-1 and S.R.66

PIA-SR66-2310-1050

Material	Concrete
Crushing resistance (vertical load test)	Pass (for wet ground conditions also)
Watertightness	Pass
Nominal capacity	3 m ³
Hydraulic efficiency	99.90 % (without filter)
Durability	Pass

Tested by:
PIA – Prüfinstitut für Abwassertechnik GmbH
Hergenrather Weg 30
52074 Aachen, Germany

This certificate is for information purposes only and replaces neither the related test report nor the declaration of performance or the CE marking. The results relate only to the tested object.



February 2025



Notified Body
No.: 1739



Certified according to
ISO 9001:2015

U Septic Tank range and its referring test reports:

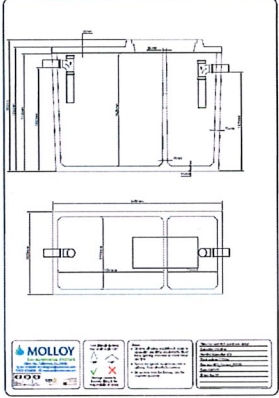
Nominal capacity Usable capacity Population equivalent (PE)	Drawing of the model of the range	Watertightness and Nominal Capacity (EN 12566-1 Annex A)	Hydraulic Efficiency (EN 12566-1 Annex B)	Structural Behaviour (EN 12566-1 Annex D)	Durability
3 3,293 l 8 PE		Pass PIA2023-WD-2310-1050B	Pass PIA2023-HWG-2310-1050	Pass PIA2023-ST-BT-2310-1050B For wet ground conditions also, installation depth 1.00 m from inlet invert	Pass PIA2012-ST-BT-1205-1032.02

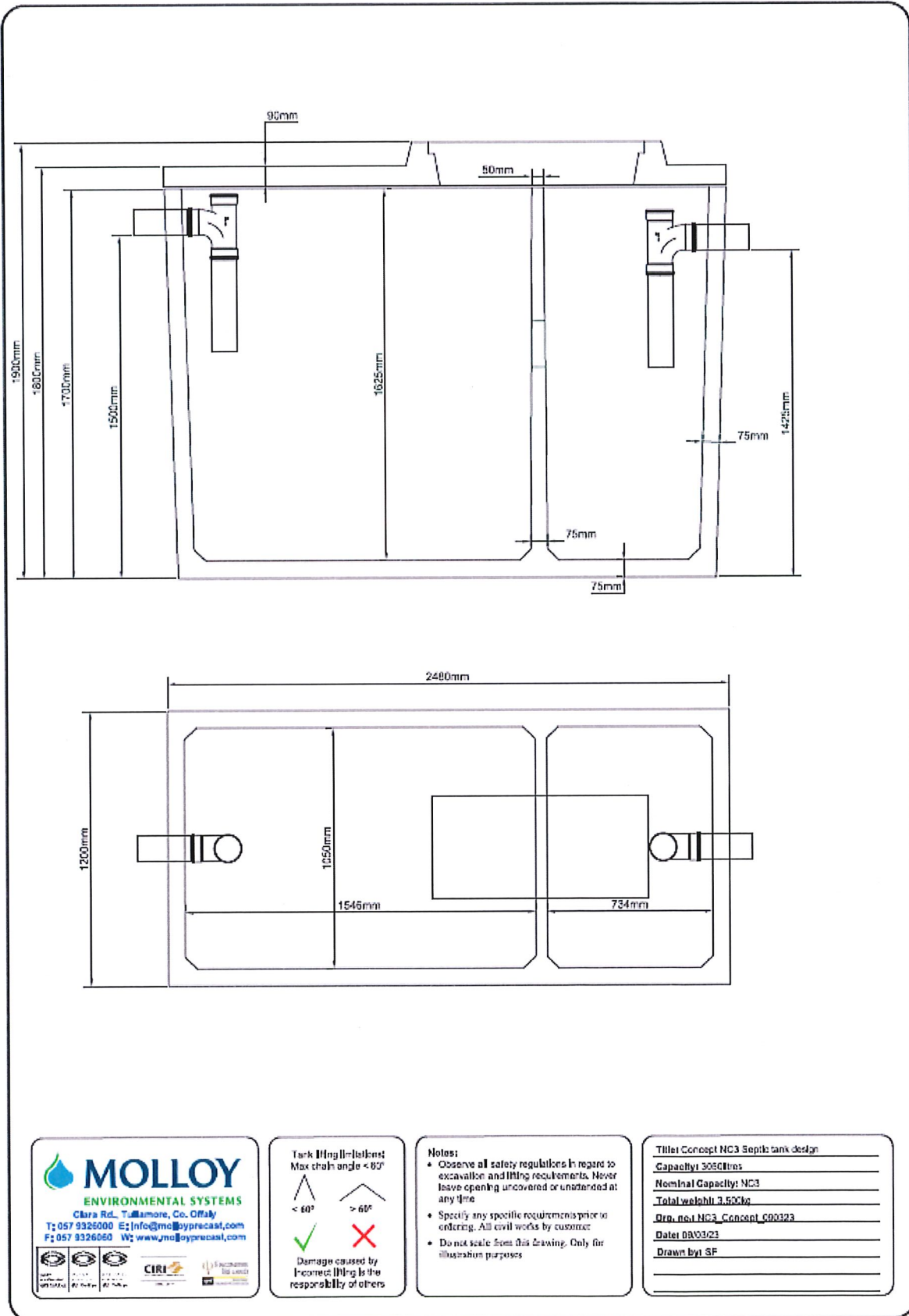

MOLLOY
ENVIRONMENTAL SYSTEMS
Clara Rd., Tullamore, Co. Offaly
T: 057 9326000 E: info@molloyprecast.com
F: 057 9326050 W: www.molloyprecast.com

Tank Lifting Information
Max chain angle <math>< 60^\circ</math>

✓ <math>< 60^\circ</math> ✗ $> 60^\circ$

Damage caused by incorrect lifting is the responsibility of others

Notes:

- Observe all safety regulations in regard to excavation and lifting requirements. Never leave opening uncovered or unattended at any time.
- Specify any specific requirements prior to ordering. All civil works by customer.
- Do not scale from this drawing. Only for illustration purposes.

Tiller Concept NC3 Septic tank design

Capacity:	3050 litres
Nominal Capacity:	NC3
Total weight:	3.500kg
Drawn:	mol NC3_Concept_090323
Date:	09/03/23
Drawn by:	SF